

User Instruction for BresleSampler® TwinTab™ Patch

Complement this instruction with information relevant for current measurement method: for example Conductometric method, Titration method or other.

1 Prepare

A. CLEANLINESS AND SAFETY

- Keep sampling equipment clean
- If necessary - use gloves



B. FIND TEST POSITION

- Identify a suitable test surface
- The test position can be horizontal, vertical, and may also be concave

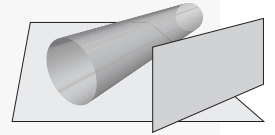

2 Position BresleSampler® TwinTab™ patch on test surface

A. REMOVE COVER

Remove both protective cover and centre filler.

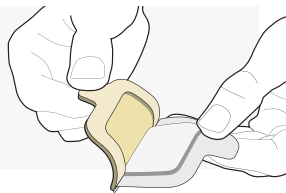

B. ATTACH

- Position the TwinTab™ patch on the selected test spot
- Press firmly to attach

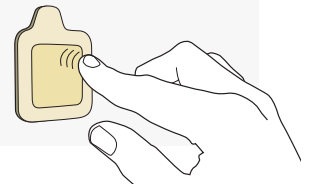

3 Inject and extract

A. FILL SYRINGE

Fill syringe with 1-5 ml washing/extraction liquid (the volume and choice of liquid determined by the final analysis that is to be performed).

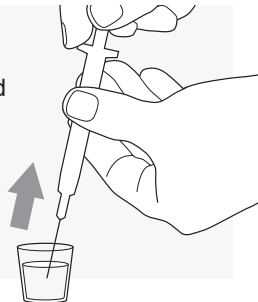

B. INJECT INTO TwinTab™ PATCH

Pierce the syringe needle through the body of the TwinTab™ patch into the sampling compartment and inject the content of the syringe.

Tip: trapped air can be sucked out with syringe to avoid high pressure.

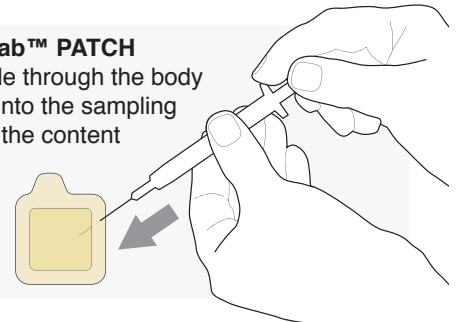

C. CREATE TURBULENCE

Carefully rub the TwinTab™ patch with your fingertip **or** suck out a part of the liquid and then fill the compartment again while maintaining the needle inserted. *This produces turbulence which improves the dissolution of the surface contaminants.*

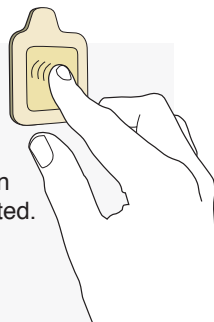

D. EXTRACT

Finally suck out and retrieve the liquid in the TwinTab™ patch and transfer it into e.g. a cylinder for further analysis.

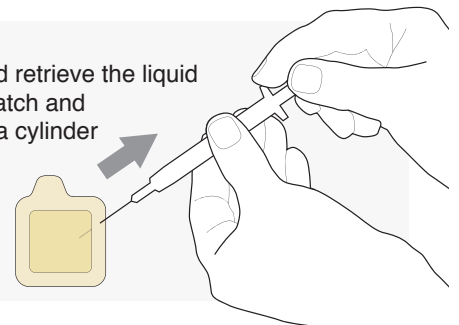

4 Remove BresleSampler® TwinTab™ patch

AFTER USE, REMOVE GENTLY

- Remove the TwinTab™ patch from the surface after use by pulling the easy-remove tab
- Adhesion can become stronger over time, making removal harder

